

PSI House

Visual Guide

Guide Content

This guide includes information about PSI House, the office of the PSI- The Pharmacy Regulator.

It includes:

- details about the areas of PSI House you may visit, and
- the services, facilities and supports available

Key Contacts

Access Officer

Email: accessofficer@psi.ie

Our Access Officers are available to support access to our information and services for people with disabilities.

General Information

Email: info@psi.ie

Phone: [+353\(0\)1 218 4000](tel:+353(0)12184000)

Arriving at PSI House

The entrance to PSI House is on Fenian Street.

The address is Pharmaceutical Society of Ireland, PSI House, 15-19 Fenian Street, Dublin 2, D02 TD72, Ireland.

When you arrive, you will enter through a glass doorway. There are four steps to the door. There is a doorbell to the right of the door.



Main Entrance

Arriving at PSI House

There is ramped/wheelchair access to the right of the front door.

We suggest you contact us in advance.

Email: accessofficer@psi.ie

Call: [+353\(0\)1 218 4000](tel:+353012184000)



Ramp access at main entrance

Ground Floor

Reception

When you arrive a staff member will welcome you and ask about the purpose of your visit.

You will be asked to write your name, organisation and time of arrival in the visitor book.

You will find the visitor book on the left, at the lower end of the desk.



Reception

Meeting a staff member

A staff member will be contacted for you. You may be asked to take a seat to wait. The staff member will guide you to your meeting or event.



Kitchen

The kitchen is located on the ground floor beside the reception area of PSI House. It is used by staff, Council and committee members.

This area can be busy and noisy.

If you need a quieter space you can ask staff about this.



Kitchen

Museum

The museum is open to visitors and is on the ground floor of PSI House.



Lift/ Stairs

A member of staff will guide you to the lift or stairs to access your meeting.



Toilets

Toilets are located opposite the lift on every floor.

A disability access single-stall toilet is available on every floor opposite the lift. There is also a wheelchair accessible toilet on the ground floor located off the kitchen.

Gender neutral toilets are located on the ground floor.



Toilets

First Floor

Meeting rooms

There are 8 meeting rooms in PSI House located on the first and second floors.



One of our meeting rooms

Meeting rooms



Inquiry room

The inquiry room is located on the first floor.

Public and private inquiries take place here. These are formal hearings held to examine complaints made to the PSI about a pharmacist or a pharmacy.

Sometimes other organisations or state agencies use this facility for inquiries also.

During an inquiry, access to all meeting rooms on the first floor is restricted to relevant parties involved with the inquiry.



Inquiry room

Press room

This room is located on the first floor. It has a window into the inquiry room. The press room is soundproof and designed for media use during public inquiries.



Press room

Second Floor

Council Room

The Council Room is located on the second floor.

The PSI Council (board) meetings take place here.

Public Council meetings are open to visitors. Visitor seating is provided on one side of the room.

This space is also used for other large meetings, staff workshops and events.



Council Room

Advisory Committee Room

The Advisory Committee Room is located on the second floor.

It is a large meeting room used for PSI Committee meetings, other meetings and interviews.

There is also a smaller meeting room opposite this room.



Advisory Committee Room

Exiting PSI House

At the end of your visit, you will be asked to note your exit time in the visitor book and guided to the exit on Fenian Street.

You can learn more about the PSI and your visit on the [PSI website](#).



Fenian Street Exit

Helpful information

- PSI House has four floors. Visitors generally only access the ground floor, first and second floors.
- For contact information and building hours visit this [webpage](#).
- There is on-street parking on Fenian Street. We are located close to Pearse Street Station and other public transport links.







Helpful information

- If you are attending an interview, please refer to your invite for information on timing and who you will meet.
- If you are attending an inquiry the start time is available on this [webpage](#), and the break times and duration of the inquiry will vary depending on the meeting.
- If you are attending a public Council meeting the agenda with timings is published on this [webpage](#).

Sensory map

We have designed a sensory map of our ground floor highlighting:

- busy areas,
- bright spaces,
- smells, and
- sounds.

Symbol description	
Stairs	
Dining	
Bright space	
Lift	
Sound	
Smell	
Busy area	

Ground floor, PSI House

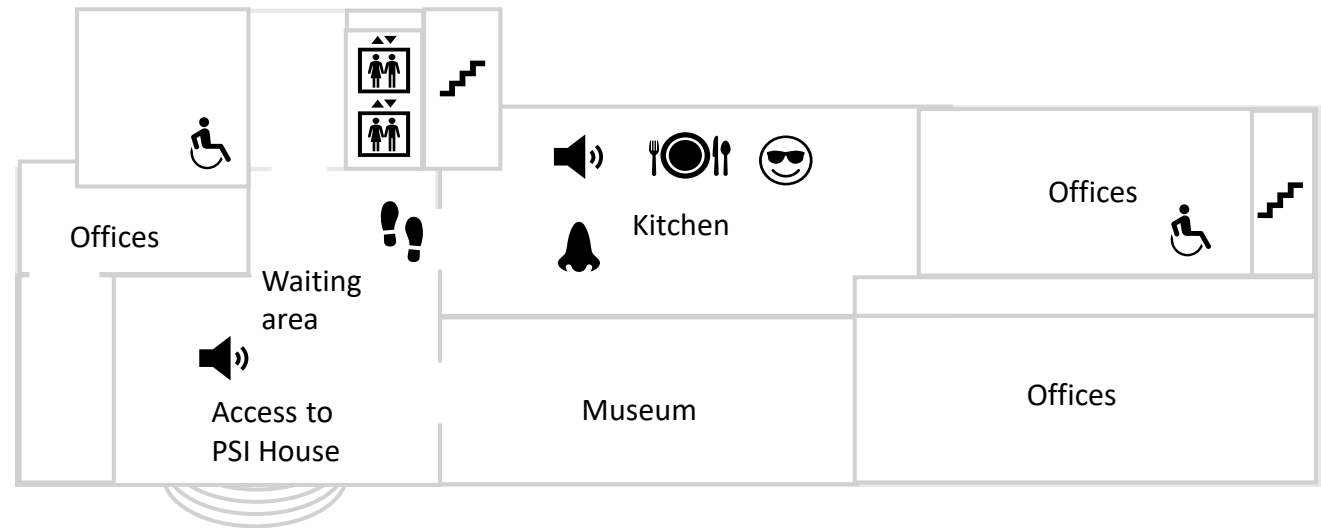

Sensory Map

Thank you for visiting PSI House.